

WOODWORKER'S JOURNAL

"America's leading woodworking authority"™



Classic Project

In this plan you'll find:

- Step-by-step construction instruction.
- A complete bill of materials.
- Construction drawings and related photos.
- Tips to help you complete the project and become a better woodworker.

Pine Wall Cabinet with Louvered Doors

Pine Wall Cabinet with Louvered Doors

This Early American style cabinet will look good in any room, although it seems particularly well suited for the kitchen or bathroom. To make it easy to build, we simplified the joinery, using a basic butt joint secured with countersunk and plugged wood screws. The fixed-louver doors are available at most lumberyards and hardware stores.

The back is made from clear pine plywood. Not all lumberyards carry clear pine, but most will order it for you. The rest of the cabinet, including the louver doors, is made from solid pine.

Before starting, it's best to have the doors on hand. The door dimensions may vary slightly from the ones we show, requiring an adjustment of our case dimensions.

Begin by making the two sides (A). Cut each one to the length and width dimensions shown in the Bill of Materials, then lay out and mark the center line locations for the adjustable shelf peg holes. Once marked, use a 1/4 in. diameter drill bit to bore each hole to a depth of 1/2 in.

As shown in Fig. 1, the back edge of each side has a 1/4 in. deep by 1/2 in. wide rabbet that's cut to accept the back (E). Note that the rabbet is stopped flush with the underside of the bottom and 1 in. from the top end. The cut can be made with a router equipped with a straight bit and an edge guide.

The curved profile on each end of the sides is shown in the side view grid patterns. Transfer the two profiles to each side, then cut them out using a hand saw or saber saw. When cutting, stay slightly on the waste side of the line. Once cut, use a file and sandpaper to sand the edge exactly to the line.

Now, cut the top and bottom (B) and the fixed shelf (C) to length and width. The roundover on the front edge of the fixed shelf can either be applied with a router and a 3/8 in. radius roundover bit or it can be hand-shaped with a file and sandpaper.

The top, bottom, and fixed shelf can now be joined to the sides. We used 1 1/4 in. long by no. 8 flathead wood screws countersunk to a depth of 1/2 in. There's no need to add glue here, since end-grain butt joints like this offer little glue strength. The plugs are glued in place and sanded flush with the surface. Also, at this time, measure the distance between the sides and cut the adjustable shelf (D) to length and width.

We used 1/4 in. thick clear pine plywood for the back (E). Rip the plywood to fit snugly between the rabbets on the back edge of the sides. Then, transfer the grid pattern to the back and cut it to shape with the band saw.

For the doors (F), we used ready-made, 1/2 in. thick by 8 in. wide by 20 in. long, pine fixed shutters. Fixed shutters have non-movable louvers. Your lumberyard will probably need to special-order them, since they will usually only stock the movable-louver shutters.



You could, if you prefer, use the movable-louver shutters—just be sure to locate the adjusting rod on the inside face of the door. Keep in mind, however, that you may need to cut a pair of notches in the front edge of the adjustable shelf to provide clearance for the adjusting rods.

Next, cut the mortises for the hinges (G) and mount the two doors. If all looks okay, remove the doors and hinges, then use the router table to apply a 3/8 in. radius to the front edge of the top, bottom and outside edges of each door. The inside edge of each door, where they meet when assembled to the case, is only slightly rounded using a file and sandpaper. The 3/4 in. dia. knobs (H) are available at just about any hardware store.

The doors, back and assembled case can now be final sanded with 220-grit sandpaper. We applied two coats of Stull's Cabinetmaker's Blue Paint to the assembled case and the two knobs. If not available from your local paint store, Stull's paint can be mail-ordered from Shaker Workshops, P.O. Box 1028, Concord, MA 01742-1028; tel. (617) 646-8985. Order part number A957. The current price is \$7.15 per pint plus \$2.45 shipping and handling. Since the back will be glued in place

The Woodworker's Journal

46

Get Adobe Reader To download these plans, you will need Adobe Reader installed on your computer. If you want to get a free copy, visit: <http://adobe.com/reader>.

Having trouble downloading the plans?
Right click on the download link and select "Save Target As..." or "Save Link As..." (depending on the web browser you are using) to download to your local drive.

Copyright Woodworker's Journal © 2010
This pattern is copyrighted by Woodworker's Journal. Purchasers of this plan may make three copies for personal use in the shop. The pattern itself, however, is the property of Woodworker's Journal and is not to be reproduced for distribution or resale. Doing so, including via any electronic methods, is a violation of copyright law.

Published in Woodworker's Journal September/October 1991

www.woodworkersjournal.com

\$1.00
WJC091

Pine Wall Cabinet with Louvered Doors

This Early American style cabinet will look good in any room, although it seems particularly well suited for the kitchen or bathroom. To make it easy to build, we simplified the joinery, using a basic butt joint secured with countersunk and plugged wood screws. The fixed-louver doors are available at most lumberyards and hardware stores.

The back is made from clear pine plywood. Not all lumberyards carry clear pine, but most will order it for you. The rest of the cabinet, including the louver doors, is made from solid pine.

Before starting, it's best to have the doors on hand. The door dimensions may vary slightly from the ones we show, requiring an adjustment of our case dimensions.

Begin by making the two sides (A). Cut each one to the length and width dimensions shown in the Bill of Materials, then lay out and mark the center line locations for the adjustable shelf peg holes. Once marked, use a $\frac{1}{4}$ in. diameter drill bit to bore each hole to a depth of $\frac{3}{8}$ in.

As shown in Fig. 1, the back edge of each side has a $\frac{1}{4}$ in. deep by $\frac{1}{2}$ in. wide rabbet that's cut to accept the back (E). Note that the rabbet is stopped flush with the underside of the bottom and 1 in. from the top end. The cut can be made with a router equipped with a straight bit and an edge guide.

The curved profile on each end of the sides is shown in the side view grid patterns. Transfer the two profiles to each side, then cut them out using a band saw or saber saw. When cutting, stay slightly on the waste side of the line. Once cut, use a file and sandpaper to sand the edge exactly to the line.

Now, cut the top and bottom (B) and the fixed shelf (C) to length and width. The roundover on the front edge of the fixed shelf can either be applied with a router and a $\frac{3}{8}$ in. radius roundover bit or it can be hand-shaped with a file and sandpaper.

The top, bottom, and fixed shelf can now be joined to the sides. We used $1\frac{1}{4}$ in. long by no. 8 flathead wood screws countersunk to a depth of $\frac{1}{4}$ in. There's no need to add glue here, since end-grain butt joints like this offer little glue strength. The plugs are glued in place and sanded flush with the surface. Also, at this time, measure the distance between the sides and cut the adjustable shelf (D) to length and width.

We used $\frac{1}{4}$ in. thick clear pine plywood for the back (E). Rip the plywood to fit snugly between the rabbets on the back edge of the sides. Then, transfer the grid pattern to the back and cut it to shape with the band saw.

For the doors (F), we used ready-made, $\frac{3}{4}$ in. thick by 8 in. wide by 20 in. long, pine fixed shutters. Fixed shutters have non-movable louvers. Your lumberyard will probably need to special-order them, since they will usually only stock the movable-louver shutters.



You could, if you prefer, use the movable-louver shutters—just be sure to locate the adjusting rod on the inside face of the door. Keep in mind, however, that you may need to cut a pair of notches in the front edge of the adjustable shelf to provide clearance for the adjusting rods.

Next, cut the mortises for the hinges (G) and mount the two doors. If all looks okay, remove the doors and hinges, then use the router table to apply a $\frac{3}{8}$ in. radius to the front edge of the top, bottom and outside edges of each door. The inside edge of each door, where they meet when assembled to the case, is only slightly rounded using a file and sandpaper. The $\frac{3}{4}$ in. dia. knobs (H) are available at just about any hardware store.

The doors, back and assembled case can now be final sanded with 220-grit sandpaper. We applied two coats of Stulb's Cabinetmaker's Blue Paint to the assembled case and the two knobs. If not available from your local paint store, Stulb's paint can be mail-ordered from Shaker Workshops, P.O. Box 1028, Concord, MA 01742-1028; tel. (617) 646-8985. Order part number A957. The current price is \$7.15 per pint plus \$2.45 shipping and handling. Since the back will be glued in place

Bill of Materials
(all dimensions actual)

Part	Description	Size	No. Req'd.
A	Side	3/4 x 5 1/4 x 33	2
B	Top/Bottom	3/4 x 5 x 14 1/2	2
C	Fixed Shelf	3/4 x 4 1/4 x 14 1/2	1
D	Adjustable Shelf	3/4 x 5 x 14 3/8	1
E	Back	1/4 x 15 1/2 x 28 1/4	1
F	Door	3/4 x 8 x 20	2
G	Hinge	1 1/4 x 1 3/4	4
H	Knob	3/4 dia.	2
I	Magnetic Catch	5/16 dia.	2

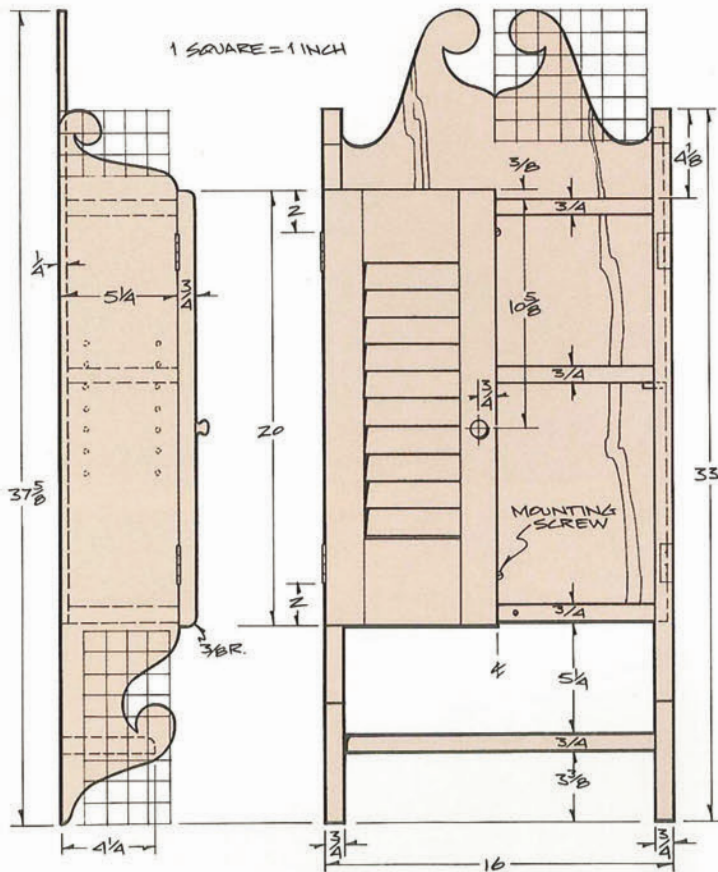
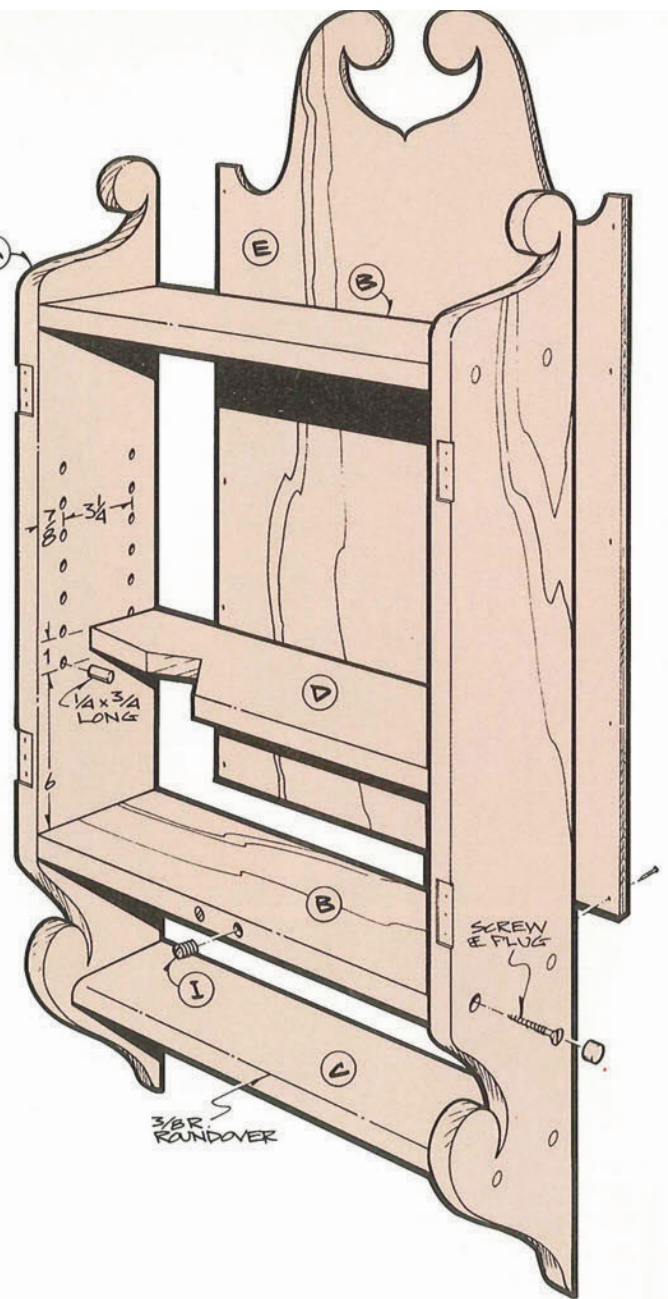
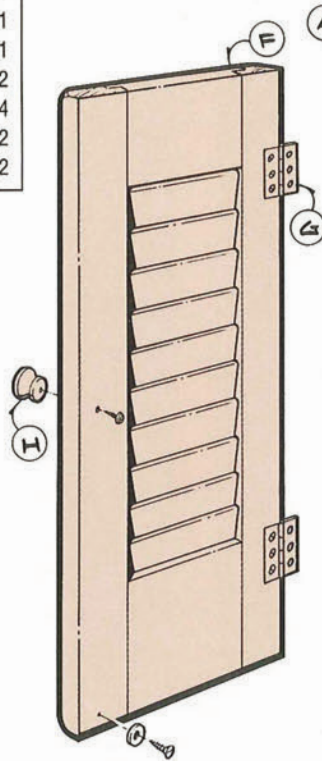
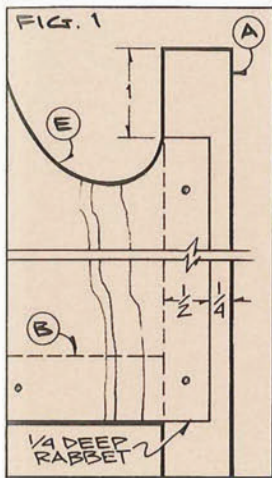

later on, you'll want to avoid getting paint in the rabbet. Any paint that gets in there will only serve to weaken the joint.

We finished the doors, back and adjustable shelf with two coats of Minwax's Puritan Pine. When dry, we added two coats of orange shellac, followed by a coat of McCloskey's Eggshell Varnish. For the reason mentioned above, the area of the back that fits into the rabbet should be protected from any finish. A strip of masking tape along each edge will do the job nicely.

Next, add the back, using both glue and box nails (or wood screws) to firmly secure it in place. Install the hinges and magnetic catches (I), then attach the doors and add the knobs. Also add the 1/4 in. diameter by 3/4 in. long dowel pegs and the adjustable shelf.

To mount the cabinet, drive a pair of wood screws through the back and into a wall stud. If you can't locate a stud, or if the stud is not in an ideal location, use a Molly bolt or other suitable wall anchor to firmly secure the cabinet in place. 

WOODWORKER'S WJOURNAL

Thank you for purchasing this *Woodworker's Journal* Classic Project plan.

Woodworker's Journal Classic Projects are scans of much-loved woodworking plans from our library of back issues. Please note that specific products and sources cited in a plan when it originally appeared may no longer be available.

If you experience any problems with this plan, please contact: info@woodworkersjournal.com

or

Attn: Classic Projects
Woodworker's Journal
4365 Willow Drive
Medina, MN 55340

Thank you again for your purchase, and happy woodworking!

Matt Becker
Internet Production Coordinator